

- NOTES:
1. ALL WORKS TO BE CONSTRUCTED IN ACCORDANCE WITH THE NRA SPECIFICATION FOR ROAD WORKS UNLESS OVERRIDDEN BY LOCAL OVERSEING AUTHORITY'S STANDARDS
 2. ALL ROAD MARKINGS & SIGNS SHALL COMPLY FULLY WITH THE TRAFFIC SIGNS MANUAL PUBLISHED BY THE DEPARTMENT OF TRANSPORT, NOVEMBER 2015.
 3. SIGNS & MARKINGS CONTRACTOR TO CONFIRM PRECISE SETTING OUT WITH EMPLOYERS REPRESENTATIVE PRIOR TO COMPLETION.
 4. ALL SIGNS TO BE MOUNTED ON 75mm GALVANISED STEEL POSTS WITH COLOURED SLEEVES U.N.O. TO SPECIFICATION AND IN ACCORDANCE WITH THE TRAFFIC SIGNS MANUAL. MOUNTING HEIGHT TO BOTTOM OF SIGN = 2.3m U.N.O.
 5. ALL TRAFFIC MANAGEMENT TO COMPLY FULLY WITH THE PROVISIONS OF CHAPTER 8 OF THE TRAFFIC SIGNS MANUAL AS PART OF THEIR TRAFFIC MANAGEMENT PLAN.
 6. ALL CO-ORDINATES ARE TO IRISH TRANSVERSE MERCATOR.
 7. ALL LEVELS ARE TO ORDNANCE DATUM AND ARE IN METRES.
 8. ALL STREET FURNITURE TO BE TAKEN UP AND SET ASIDE FOR RE-USE. PROPOSED STREET FURNITURE TO BE RETROFITTED BY OTHERS.
 9. ALL EXISTING SIGNS (INCLUDING POLES) AND MARKINGS TO BE TAKEN UP OR COVERED AND TEMPORARY MEASURES APPLIED IN ACCORDANCE WITH CONTRACTORS TRAFFIC MANAGEMENT PLAN. THE CONTRACTOR MAY USE EXISTING SIGNAGE AS PART OF THEIR TRAFFIC MANAGEMENT PLAN.
 10. ALL EXISTING CHAMBERS AND ACCESS POINTS TO REMAIN CLEAR OF OBSTRUCTION THROUGHOUT WORKS. CHAMBERS SHALL BE REBUILT/RETAINED IN POSITION IDENTIFIED ON FINISHING WORKS DRAWING.
 11. ALL PEDESTRIAN, CYCLE AND VEHICULAR ROUTES MUST BE RETAINED IN ACCORDANCE WITH APPROVED TRAFFIC MANAGEMENT PLAN.
 12. ALL MATERIALS TO BE DISPOSED OFF SITE SHALL BE TAKEN TO A LICENSED FACILITY APPROVED BY THE LOCAL OVERSEING AUTHORITY.
 13. THE CONTRACTOR MUST LAISE DIRECTLY WITH LOCAL AUTHORITY DEPARTMENTS AS DIRECTED IN THE WORKS REQUIREMENTS.
 14. ALL VEHICULAR & PEDESTRIAN, CYCLE & PRIVATE ACCESS ROUTES WITHIN AND SURROUNDING THE WORKS EXTENTS MUST BE MAINTAINED THROUGHOUT THE WORKS IN ACCORDANCE WITH THE CONTRACTORS APPROVED TEMPORARY TRAFFIC & OPERATIONS MANAGEMENT PLAN.

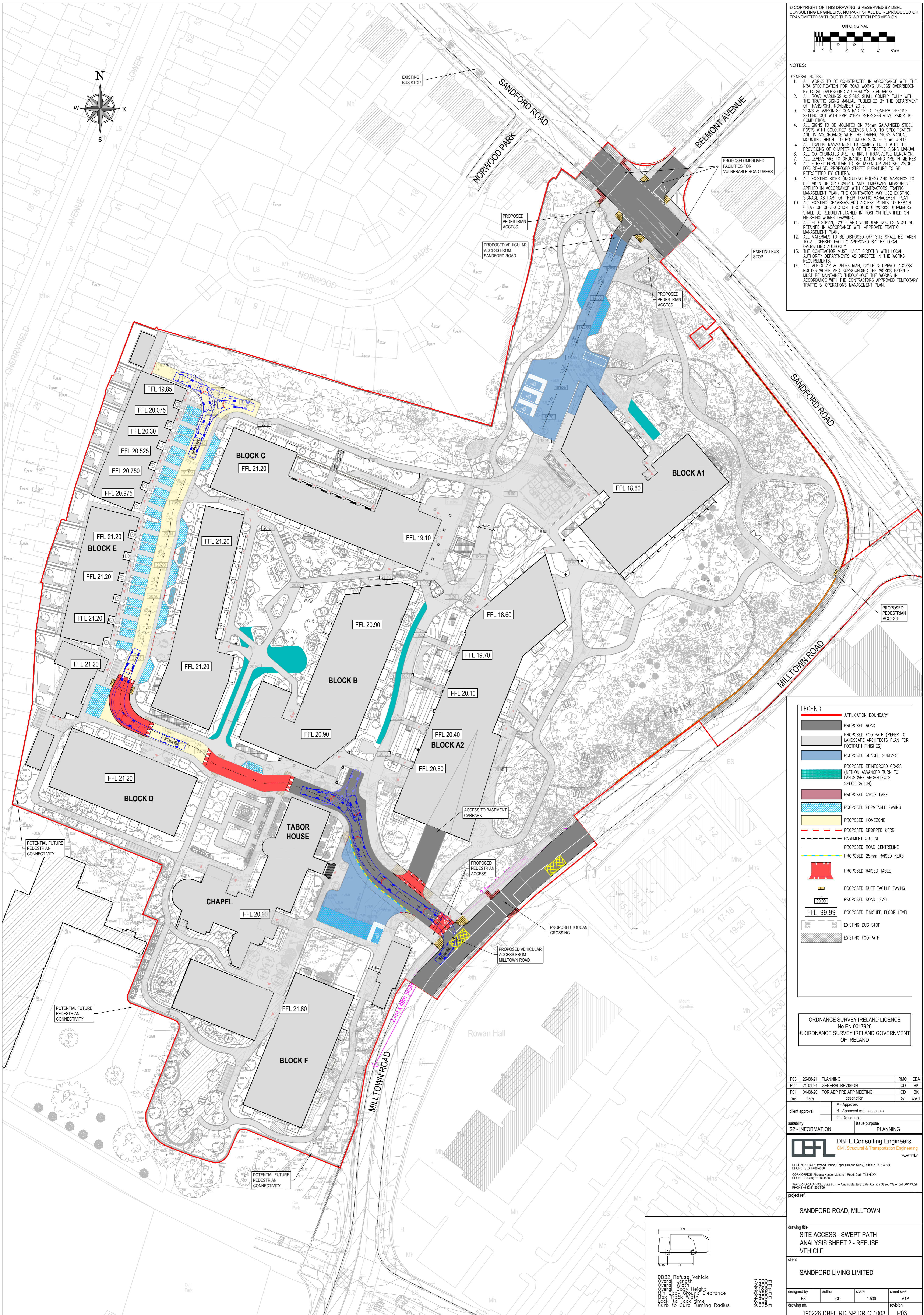

LEGEND

- APPLICATION BOUNDARY
- PROPOSED ROAD
- PROPOSED FOOTPATH (REFER TO LANDSCAPE ARCHITECTS PLAN FOR FOOTPATH FINISHES)
- PROPOSED SHARED SURFACE
- PROPOSED REINFORCED GRASS (NETLON ADVANCED TURN TO LANDSCAPE ARCHITECTS SPECIFICATION)
- PROPOSED CYCLE LANE
- PROPOSED PERMEABLE PAVING
- PROPOSED HOMEZONE
- PROPOSED DROPPED KERB
- BASEMENT OUTLINE
- PROPOSED ROAD CENTRELINE
- PROPOSED 25mm RAISED KERB
- PROPOSED RAISED TABLE
- PROPOSED BUFF TACTILE PAVING
- PROPOSED ROAD LEVEL
- FFL 99.99 PROPOSED FINISHED FLOOR LEVEL
- EXISTING BUS STOP
- EXISTING FOOTPATH

ORDNANCE SURVEY IRELAND LICENCE
No EN 0017920
© ORDNANCE SURVEY IRELAND GOVERNMENT OF IRELAND

P03	25-08-21	PLANNING	RMC	EDA
P02	21-01-21	GENERAL REVISION	ICD	BK
P01	04-08-20	FOR ABP PRE APP MEETING	ICD	BK
rev	date	description	by	chkd.
		A - Approved		
		B - Approved with comments		
		C - Do not use		

client approval: S2 - INFORMATION issue purpose: PLANNING

DBFL Consulting Engineers
Civil, Structural & Transportation Engineering
www.dbfl.ie

DUBLIN OFFICE: Omrod House, Upper Omrod Quay, Dublin 7, D07 W7D4
PHONE: +353 (0) 1 452 4000

CORK OFFICE: Phoenix House, Morahan Road, Cork, T12 H1Y1
PHONE: +353 (0) 21 2024638

WATERFORD OFFICE: Suite 8b The Atrium, Martins Gate, Canada Street, Waterford, X91 W028
PHONE: +353 (0) 51 508 500

project ref: SANDFORD ROAD, MILLTOWN

drawing title: SITE ACCESS - SWEEP PATH ANALYSIS SHEET 2 - REFUSE VEHICLE

client: SANDFORD LIVING LIMITED

designed by:	author:	scale:	sheet size:
BK	ICD	1:500	A1P
drawing no.:			revision:
190226-DBFL-RD-SP-DR-C-1003			P03

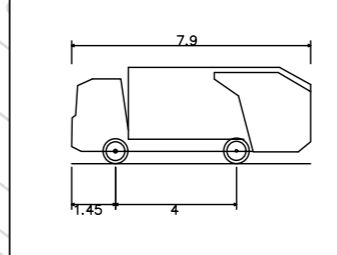

DB32 Refuse Vehicle
Overall Length 7.900m
Overall Width 2.400m
Overall Body Height 1.183m
Min Body Ground Clearance 0.385m
Max Track Width 2.400m
Lock-to-lock time 6.00s
Curb to curb turning Radius 9.620m